



"Yogi" Multicat 2611

Aventurijn 202
3316 LB Dordrecht
The Netherlands
T: +31 (0)78-6192507
E: chartering@hermansr.com
I: www.hermansr.com



GENERAL
Yard no. : 1593 {Damen Shipyards Hardinxveld}
Delivery date : May 2008
Type : Damen Multicat 2611
Basic functions : Towing, anchor handling , dredge support.
Classification : Bureau Veritas I 3/3 {E} * Tug
Unrestricted Area * MACH
Nat. Authorities : Dutch Shipping Inspection
30 miles from coast/ continuous service
Call sign : PCYP
I.M.O. No. : 9479785
MMSI No. : 244820283

DIMENSIONS
Length : 26.00 m
Width : 11.50 m
Depth at sides : 3.50 m
Depth aft. : 2.40 m
GT / NT : 255 GT / 76 NT

TANK CAPACITIES
Fuel oil : 120.00 m³
Fresh water : 48.00 m³
Sewage : 9.20 m²
Dirty oil : 2.10 m²
Lub. oil : 1.50 m³
Hydraulic oil : 1.50 m³
Bilge water :

PERFORMANCES
Bollard pull : 31 ton (m)
Speed : 10.0 knots

PROPULSION SYSTEM
Main engines : 3 x Caterpillar 3412 D TTA
Total power : 1790 bkW (2435 bhp) at 1800 rpm
Gearboxes : 3 x Reintjes WAF 564L/5.591:1
Propulsion : 3 x Promarin fixed pitch propellers
Diameter : 3 x 1700 mm in v.d. Giessen Optima nozzles
Bowthruster : 1 x 200 Kw
Rudders : 3x fishtail rudders, 45 degrees

AUXILIARY EQUIPMENT
Generator sets : 1 x John Deere 6068 TF258 107 KW, 50 hz
1 x John Deere 4045 TF258 85 Kva 50 hz
Hydraulic set : 1 x Caterpillar C 18, 357 KW
Fuel separator : Alfa Laval MAB 103
Compressors : 2 x 210 ltr/min + 1 x 940 ltr/min
Transfer pumps : for water and fuel: SIHI 50 m3/hr at 1,5 bar

DECK LAYOUT
Anchors : 2 x 225 kg Pool
Chain : 192.5 m shortlink 17,5 mm
Anchor winch : Ridderinkhof , hydraulic
Deck crane fore ship : Heila HLRM 240- 2 S/DRG 16 T. @ 12 m
Deck crane aft ship : Heila HLRM 200- 4 SL 9 T. @ 16 m
Anchorhandling : Pull 100 T- 5 m/min wire 600 m dia. 52 mm
Towing winch : Pull 50 T- 10 m/min wire 600 m dia. 42 mm
Tuggerwinch : Argano S 100
Capstan : WK Hydraulics 5 ton @ 30 m/min
Anchorhandling : 2 sets of towing/anchorhandling pins
Towing hooks : 2 x Mampaey
Towing pins : 2 sets Hydraulic towing/anchorhandling pins
Maximum deckload : 10 ton/m²
Free deck space : 150 m²

ACCOMODATION
Heated and airconditioned living spaces for 6 persons, consisting of 3 double cabins, a galley and sanitary facilities

NAUTICAL AND COMMUNICATION EQUIPMENT
According GMDSS : Area A3
Searchlights : Seematz 2 x 1000 W
Compass : Kötter type, electric repeater
Radar system : Furuno FR-2117+ ARPA
GPS : Furuno GP-150-D
Plotter : Transas
Gyro compass : Tocimec ES-160 + Lehmkuhl LR-60 repeater
Autopilot : Radio Holland Sea river pilot 75
Echosounder : Furuno FE 700
VHF radio telephone : 3x sailor 5022 with DSC
Navtex : Radio Holland Nav 5
AIS : Furuno FA 150
SSB : Furuno FS-1570 , 150 W.
Communication : Inmarsat C + Iridium Satellite telephone

For more information about chartering please contact us
Telephone: +31 (0)78 619 25 07 - Email: chartering@hermansr.com



“Yogi”
Multicat 2611

Aventurijn 202
3316 LB Dordrecht
The Netherlands

T: +31 (0)78-6192507
E: chartering@hermansr.com
I: www.hermansr.com

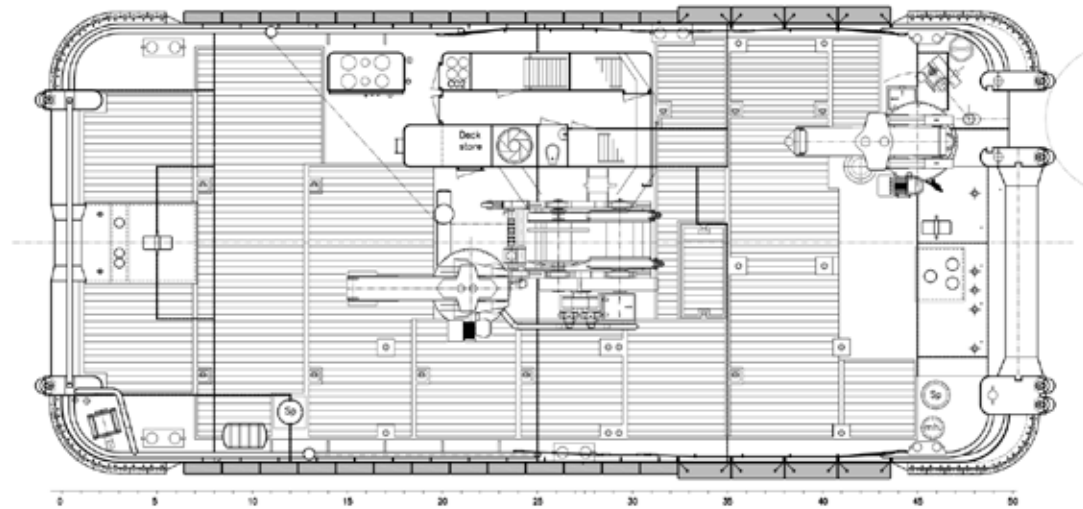
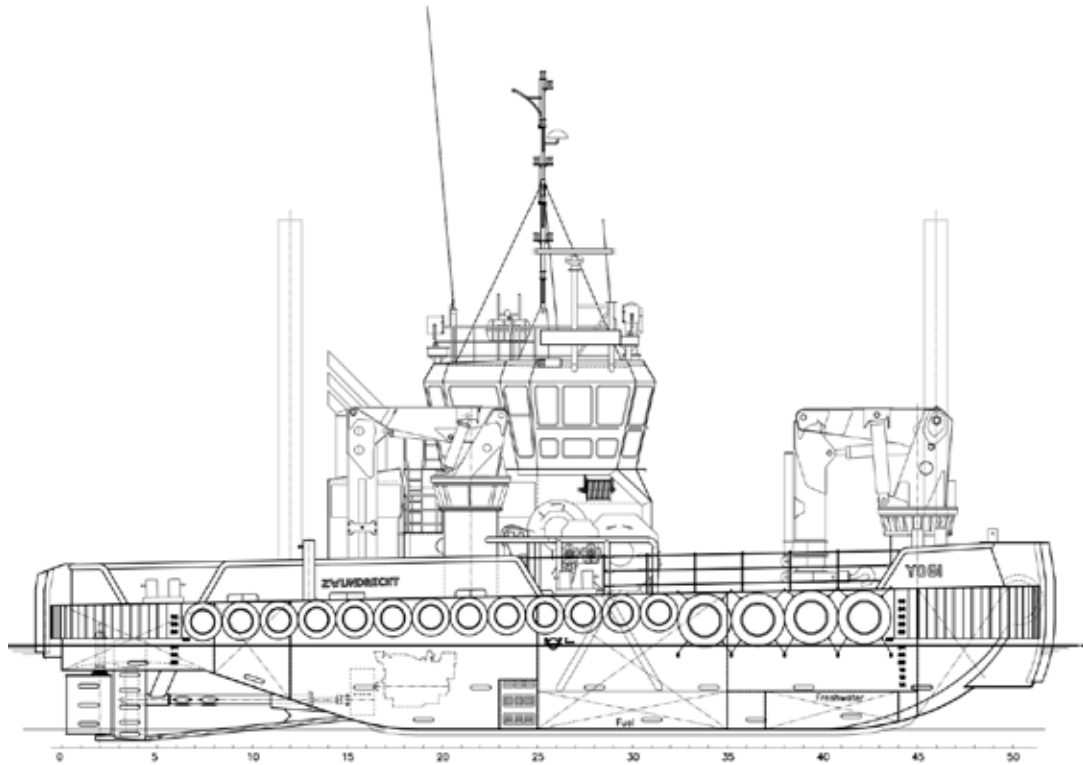

For more information about chartering please contact us
Telephone: +31 (0)78 619 25 07 - Email: chartering@hermansr.com