



# "Barney" Shoalbuster 3013

Aventurijn 202  
3316 LB Dordrecht  
The Netherlands  
T: +31 (0)78-6192507  
E: chartering@hermansr.com  
I: www.hermansr.com



## GENERAL

Type : Shoalbuster 3013  
Basic functions : Towing, Anchor handling, Dredge support, Supply, Survey, Windfarm support, Diving support, 4-point mooring system, pull vessel  
Classification : Bureau Veritas I \* HULL • Tug Unrestricted navigation, anchor handling notation  
Nat. Authorities : Dutch Shipping Inspection continuous service  
Callsign : PCZU  
IMO No. : 9740938  
MMSI No. : 244850156

## DIMENSIONS

Length : 30.02 m  
Width : 13.46 m  
Depth at half length : 3.20 m  
Draft min. : 1.80 m  
GT/NT : 382 / 114 Ton

## TANK CAPACITIES

Fuel oil : 135.00 m<sup>3</sup>  
Fresh water : 40.00 m<sup>3</sup>  
Sewage : 18.70 m<sup>3</sup>  
Dirty oil : 2.30 m<sup>3</sup>  
Lub. oil : 3.40 m<sup>3</sup>  
Hydraulic oil : 2.00 m<sup>3</sup>  
Gearbox oil : 0.50 m<sup>3</sup>  
Bilge Water : 3.40 m<sup>3</sup>

## PERFORMANCES

Bollard pull : 30 tons (m) (approx.)  
Speed : 10.5 knots

## PROPULSION SYSTEM

Main engines : 3x Caterpillar C18 ACERT  
Total power : 1599 bkW (2145 bhp) @ 1825 rpm  
Gearboxes : 3x Reintjes WAF 364L / 5,435:1  
Propulsion : 3x Promarin fixed pitch propeller  
Diameter : 3x 1600 mm in nozzles  
Bowthruster : 250 bhp, hydraulically driven  
Rudders : 3x Fishtail rudders, 45 degrees

## AUXILIARY EQUIPMENT

Generator sets : 2x Cat C-4.4 TA 107 kVA, 50 Hz 230/400V  
Hydraulic set : Combined Cat C18 with Gearbox with clutch

Fuel separator : 1x Alfa Laval Mib 303  
Compressors : 1x Capacity 950 L / Min 2x 175 L / min  
Transfer pumps : 1x water 1x fuel : SIHI 32 m<sup>3</sup>/hr at 3.5 bar  
Sewage Treatment : 1x Hamman Super mini cap. 12 persons

## DECK LAYOUT

Anchors : 2x 340 kg Pool (HHP)  
Chain : 19 mm short-link anchor chain 220m  
Anchor winch : 2x DMT hydraulically driven, 2x drum with pull 5,5 Ton @ 1st layer, wire 300m, Ø 24mm  
Deck crane aft : HS Marine AKC 185 HE4, 6440kg @ 17,07m  
Deck crane front : HS Marine AK 20 LE1, 2055kg @ 7,28m  
Towing winch/ anchor handling : DMT 3 drums 50 tons, 2x650m @ Ø38 mm 1x 150m @ Ø44mm, @ 6m/min 75 ton BHF  
Towing pins : 4x Hydraulic anchorhandling pins  
Wire/ chain stopper : 1x wire / chain stopper 50T SWL  
Tugger winch : 2x Dromec HPV-12000 12T @ 12m/min  
Moonpool : 1x moonpool with a diameter of 386 mm  
: 1x moonpool 600 x 800 mm  
Maximum deckload : 10 ton /m<sup>2</sup>  
Free deck space : 150 m<sup>2</sup>

## ACCOMODATION

Heated and air-conditioned living spaces for 12 persons, consisting of a captain's cabin, 1 single crew cabin and 2 double crew cabins, 3 double passenger cabins, a galley / mess and sanitary facilities.

## NAUTICAL AND COMMUNICATION EQUIPMENT

According GMDSS : Area A3  
Searchlights : 2x Pesch 3000 W  
Gyro compass : 1x Anschuetz Std 22 Compact  
Radar system : 1x Furuno FAR-2117  
D-GPS : 1x Simrad MX 521-A  
AIS : 1x Furuno FA-150  
ECDIS : 2x Furuno ECDIS  
Autopilot : 1x Simrad FU-80  
Echosounder : 1x Furuno FE 700  
Watch alarm : 1x Furuno BR-540  
VHF radio telephone : 3x sailor RT 6222 25W  
Navtex : 1x Furuno NX 700  
SSB/DSC : 1x Sailor 6310  
Inmarsat-C : 2x Sailor 6110  
Satellite : 1x Iridium telephone  
Vsat : 1x Intellian VSAT v100GX  
CCTV : 1x Orloco 8 Cameras system

For more information about chartering please contact us  
Telephone: +31 (0)78 619 25 07 - Email: chartering@hermansr.com



# “Barney” Shoalbuster 3013

Aventurijn 202  
3316 LB Dordrecht  
The Netherlands

T: +31 (0)78-6192507  
E: [chartering@hermansr.com](mailto:chartering@hermansr.com)  
I: [www.hermansr.com](http://www.hermansr.com)

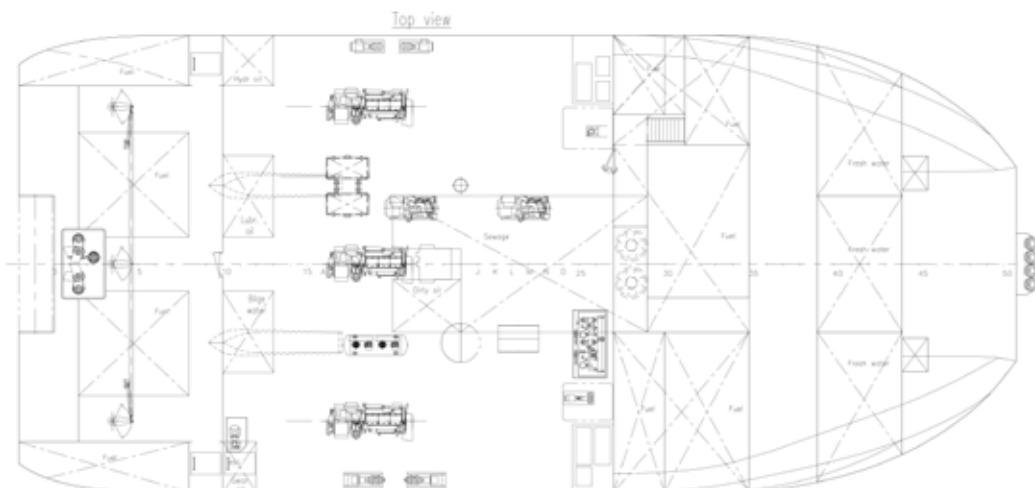
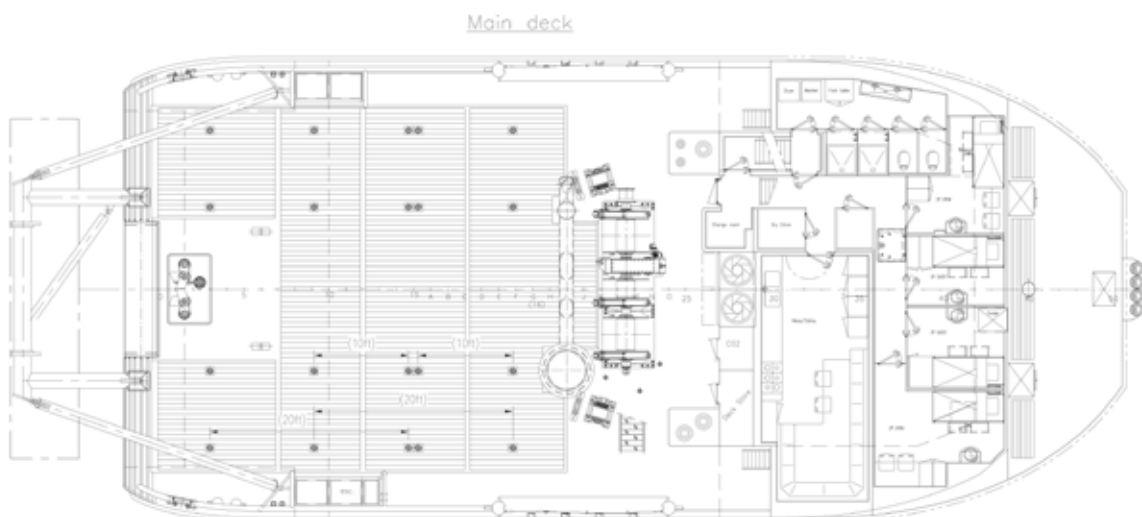
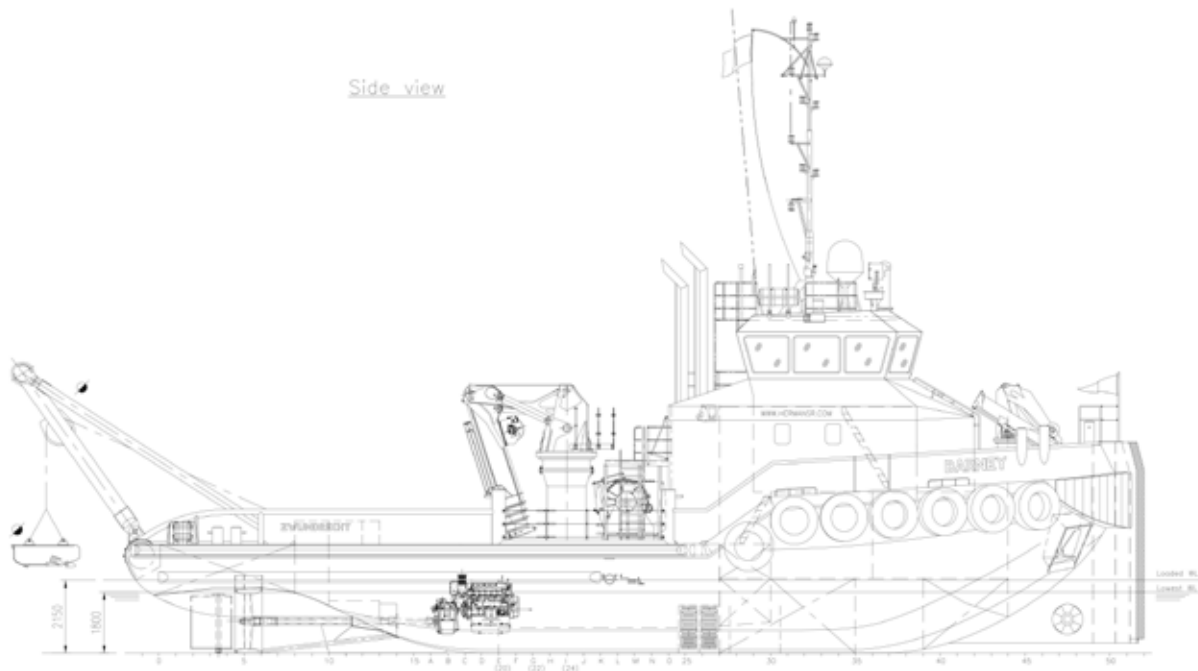

For more information about chartering please contact us  
Telephone: +31 (0)78 619 25 07 - Email: [chartering@hermansr.com](mailto:chartering@hermansr.com)